

1. SELECT DIAMETER OF BULK HEAD PASS-THRU.
2. PROVIDE WALL THICKNESS PER DRAWING BELOW.
3. CHOOSE CAP STYLE GASKETED OR CLOSED

## BULK HEAD PASS THRU SUBMITTAL FORM

**BULK HEAD Pass-throughs** shall be manufactured from polyolefin resin and shall conform to ASTM #1412-92 for corrosion resistance and material content. BULK HEAD Pass through will be IPS size 1.5, 2.0, 3.0, 4.0, or 6.0 inch as required with either a gasketed or closed cap. Pass through will be manufactured by Scientific Plastics, Inc. of Kansas City, KS, USA

### #1 CHOOSE SIZE

### #2 WALL THICKNESS

### #3 CHOOSE CAP

### ISOMETRIC VIEW

CHECK  
BOX

- 1.5" DIAMETER
- 2" DIAMETER
- 3" DIAMETER
- 4" DIAMETER
- 6" DIAMETER

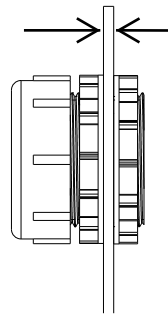

OVERALL LENGTH OF PIPE WILL BE  
BASED ON DIAMETER OF PASS THRU

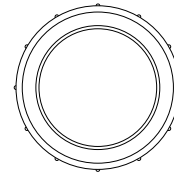

CLOSED CAP

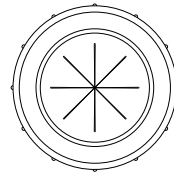

GASKETED CAP

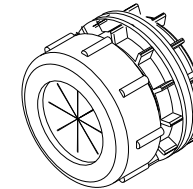
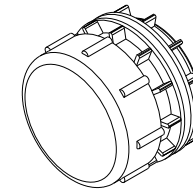

### HOLE SIZE REQUIRED FOR INSTALLATION

#### SIZE

- 1.5" 1.9 OD
- 2" 2.375 OD
- 3" 3.5 OD
- 4" 4.5 OD
- 6" 6.5 OD

CUSTOMER APPROVAL SIGN HERE \_\_\_\_\_

QTY OF PASS THRU \_\_\_\_\_

<b>BULK HEAD PASS THRU SUBMITTAL FORM</b>	
DESCRIPTION:	<b>SCIENTIFIC PLASTICS COMPANY</b>
<div style="display: flex; justify-content: space-between;"> <span>DWG BY: Philip Llamas</span> <span>DATE: 4/13/21</span> </div>	<p>1016 SOUTHWEST BLVD KANSAS CITY KS 66103 (913)-432-0322 OFFICE (913)-432-0459 FAX</p>