

Rectangular Tanks

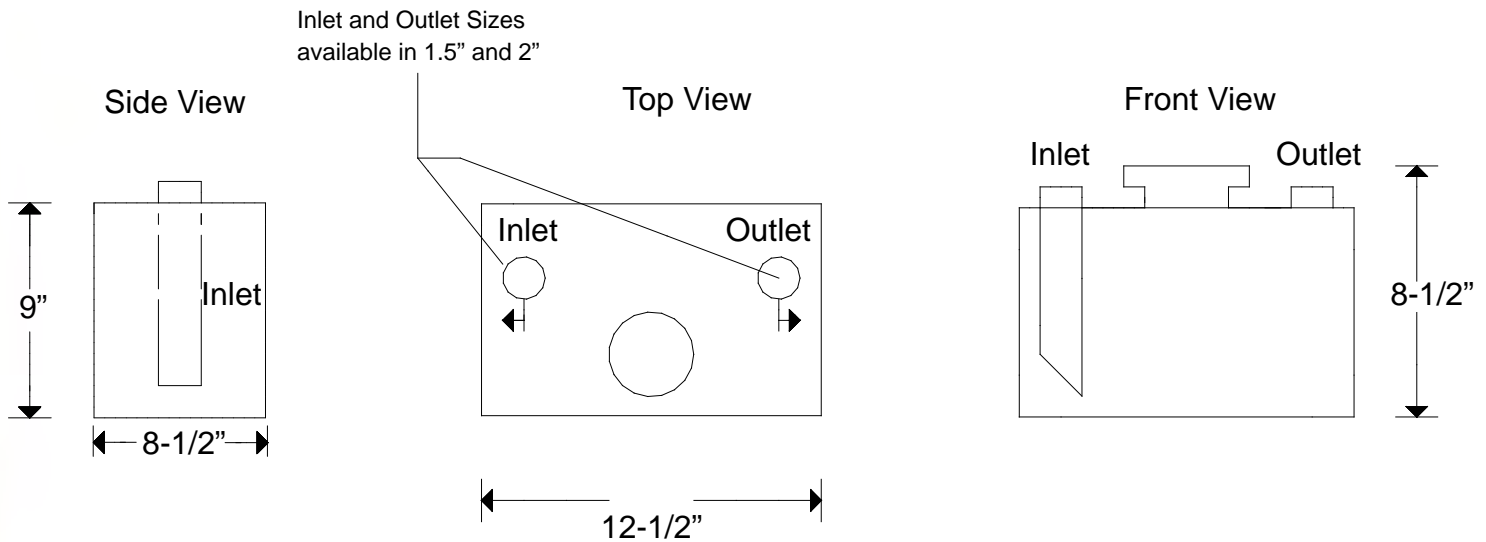

| Capacity | Inlet-Outlet | Inside Dimensions |
|----------|--------------|-------------------|
| 1.5 gal. | 1-1/2" | 10" x 9" x 6" |
| 1.5 gal. | 2" | 10" x 9" x 6" |

Rectangular Tanks/Traps

Rectangular tanks are designed for use at point of application. These tanks have a 1-1/4 gallon capacity. Without limestone these tanks serve as a dilution tank or a sink trap. they can also be used with limestone for neutralization. A 3" clean out cap can be installed in the side of the tank or on top to provide best access.

Note: Specify inlet and outlet sizes at the time of order.